

LAS POSAS VALLEY AREA

- ① ASPEN ROAD
- ② CRESTON LANE NORTH
- ③ HEATHERTON DRIVE
- ④ HEATHERTON DRIVE
- ⑤ KINGSGROVE DRIVE EAST
- ⑥ PALOMINO CIRCLE
- ⑦ PALOMINO CIRCLE
- ⑧ PALOMINO DRIVE
- ⑨ LA CUMBRE ROAD

MOORPARK AREA

- ⑩ BALCOM CANYON ROAD
- ⑪ BALCOM CANYON ROAD
- ⑫ BALCOM CANYON ROAD

SURFACE TREATMENTS

- 1-1/2" A.C. WITH FIBER OVER ARAM.
- JOINTED PLAIN CONCRETE PAVEMENT
- TYPE-II EMULSION AGGREGATE SLURRY

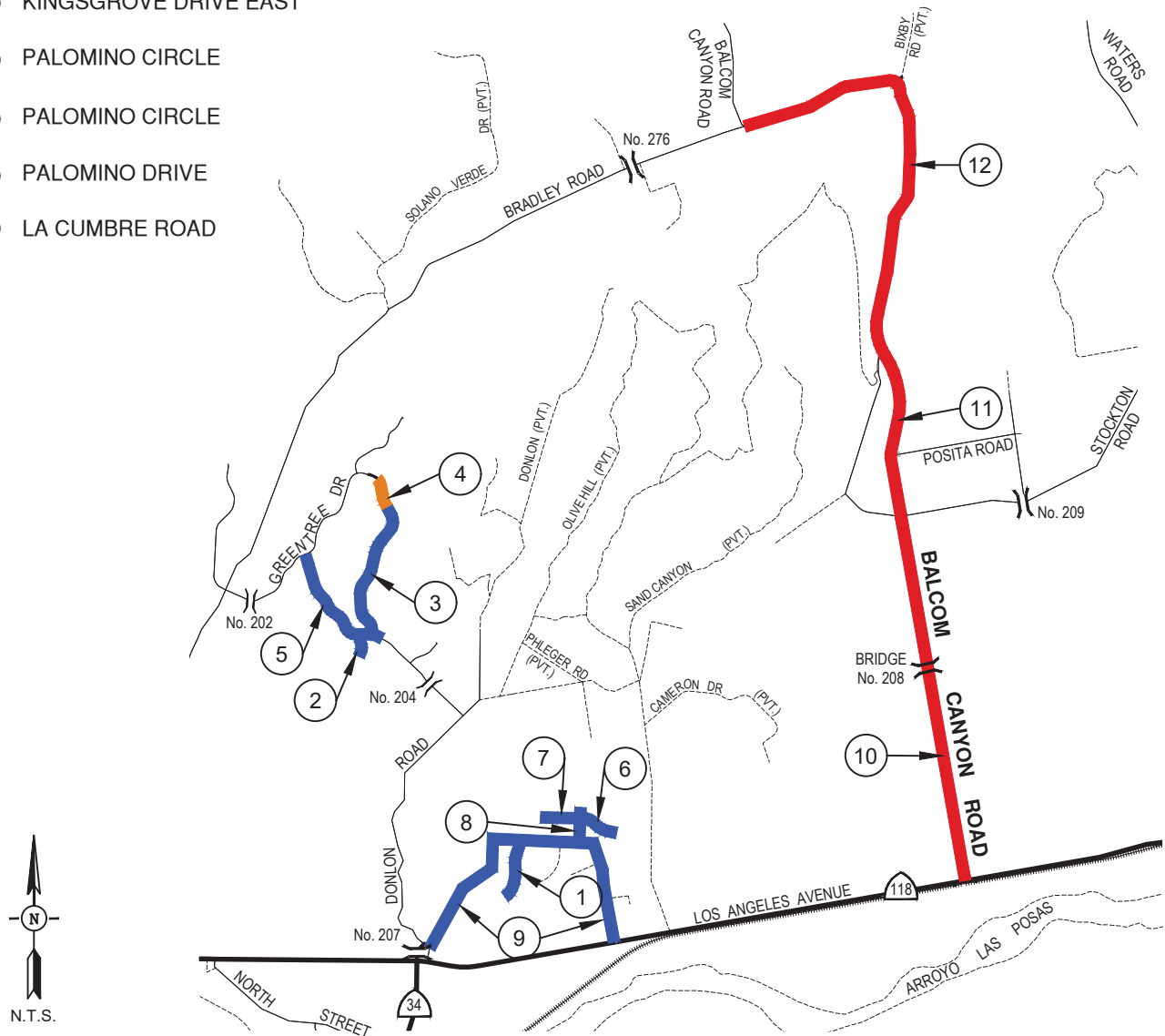

COUNTY OF VENTURA PUBLIC WORKS AGENCY ROADS & TRANSPORTATION PAVEMENT RESURFACING LAS POSAS VALLEY & BALCOM CANYON ROAD PROJECT No. 50627 LOCATION MAP