

## MEMORANDUM

---

**To:** Randy Michaels  
**From:** Hanna Dodd, P.E.  
**Subject:** Response to PL 18-0052  
**Date:** 10/15/2018  
**Attachment(s):** Camp Ramah Existing Accounts with Casitas Municipal Water District, Camp Ramah Estimated Attendance Record 9/2017 – 8/2018, Casitas Municipal Water District Meter Data for Camp Ramah

---

On June 1, 2018, the Ventura County Watershed Protection District (VCWPD) – Groundwater Resources Section (County) wrote a letter to Camp Ramah requesting clarifications about the Camp's Major Modification to its existing Condition Use Permit (CUP) before Ventura County approves the Major Modification.

This memorandum provides responses to the four (4) items requested by VCWPD – Groundwater Resources Section in their June 1, 2018 letter.

### 1 Major Modification Project Description

Camp Ramah in California, Inc. (Camp) requested approval from Ventura County for a Major Modification to its existing Conditional Use Permit (CUP 3048). The Major Modification would include:

- **Machon "Village" Space:** New 10,609 square-foot space consisting of six (6) new cabins with a central gathering area to include counselor sleeping quarters, prep kitchen, meeting spaces, storage and restrooms.
- **Reception/Storage Area:** A 1,151 square-foot reception/storage area added to the existing Dining Hall.
- **Drop-off Area:** Reconfiguration of existing drop-off area.
- **Adding Parcels to CUP:** Incorporating three (3) recently purchased parcels into the CUP (**Figure 1:** APNs 010-0-060-030, 010-0-060-070, & 0100-070-310).

It should be noted that Major Modification will not increase the number of camp guest or staff; the additional buildings add a new programing space for the existing 11<sup>th</sup> grade campers.

County of Ventura Planning Commission Hearing Case No. PL18-0052 Exhibit 4 (MND), Attachment 7 - Dudek Water Allocation Report, dated October 15, 2018
--

## 2 Responses to VCWPD – Groundwater Resources Section

Based on the information provided to the County before June 1, 2018, the County could not determine whether the proposed project would have a significant impact on available groundwater and water supply resources. In their June 1, 2018 letter to the Camp, the County requested the following additional information:

1. Clarify whether the allocation from the Casitas Municipal Water District (District) is for one parcel or all of the site's parcels and submit evidence of water allocations for the other parcels (if applicable);
2. Submit a Projected Water Demand (water requirements) for the project with verifiable water demand rates; and,
3. Provide total water use from all sources from a representative base period of at least 10 years to allow for adequate water analysis. The water use data must be copies of the original District water bills or printed on District letterhead to serve as empirical evidence of actual water usage.
4. Provide any metered groundwater extraction data if available.

This section gives responses to these four (4) items.

### 2.1 Casitas Municipal Water District Allocation

In order to confirm the water allocation from the District for the Camp, the District was asked to provide information about Camp's current water allocation for any Camp water accounts. In September 2018, the District provided information to confirm the water allocations associated with the Camp's two existing water accounts with the District, which confirmed an allocation of 37.05 AFY for the Camp's main camp parcels (APNs 010-0-110-130, 101-0-110-120, 010-0-120-040, 010-0-070-030). The allocation information provided by the District for this response is included in **Attachment A. Table 1** provides the water use allocations for each of the Camp accounts and the parcels associated with each account, as provided by the District. **Figure 1** presents the parcel layout for the Camp.

The allocation value provide by the District in September 2018 is different than that from information the District previously provided the County in the Will Serve Letter dated March 16, 2018. The allocation data previously provided to the County from the District (29 AFY for APN 010-0-110-130) did not take into consideration a transfer of allocation from one parcel (APN 010-0-170-020) to the Camp's main camp parcels which occurred in September 2017. With the transfer, the Camp's main parcels have an allocation of 37.05 AFY.

**Table 1: Camp Ramah's Water Allocation from District**

Parcel APN(s)	Account No.	District Water Allocation (AFY)
010-0-110-130 010-0-110-120 010-0-120-040 010-0-070-030	41-25674-00	37.05
010-0-170-020	40-25682-01	9.04
010-0-070-310	-	-
010-0-060-070	-	-
010-0-060-030	-	-

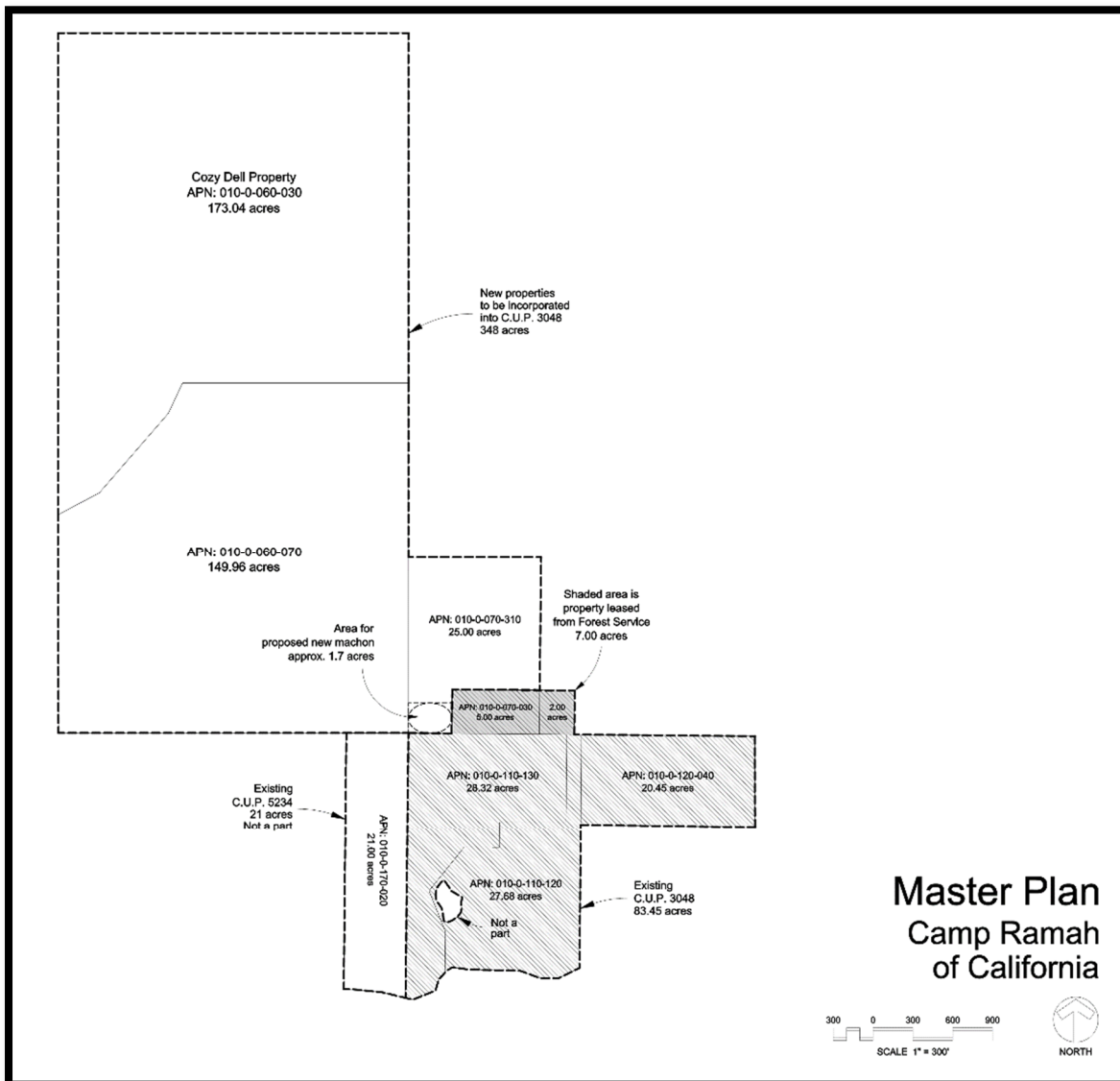

Figure 1 - Parcel Map

## 2.2 Projected Water Demand

The annual project water demand for Camp Ramah after the Major Modification is calculated by summing the total estimated water use of the Camp, which includes usage by camp guests and staff (people), swimming pool evaporation, reservoir evaporation and irrigation.

### 2.2.1 Estimated Water Use by Camp Guests and Staff

Since the Major Modification will not increase the number of camp guests and staff, the total number of people at Camp Ramah in future years is not expected to increase; therefore, recent guest and staff count information was used to project water usage consumption. Camp guest attendance records from September 2017 to August 2018 (**Attachment B**) were approximately 7,800 campers. There were 315 temporary staff for the summer camp between mid-June 2018 and mid-August 2018. There were 21 permanent staff working at Camp Ramah all year round.

**Table 2** presents a monthly calculation of the average amount of people at the Camp Ramah in any given month. Their monthly water usage was calculated to account for the water usage of camp guests, permanent staff and temporary staff over a one year period. The monthly averages of people assumed that a person who was only at Camp Ramah for one week during the month averaged out to one fourth (1/4) of a person for that month. Each average person was assumed to use 55 gallons per day (i.e. the required indoor per person water use goal for the year 2025 in California SB 606 and AB 1668, which is a value many California cities like San Francisco and Santa Cruz already meet). This calculation projected that people at Camp Ramah would use approximately 21 AFY.

**Table 2: Estimated Water Use of People at Camp Ramah**

Month	Year	Estimate Average Number of Guests	Estimated Average Number of Temporary Staff	Permanent Staff	Estimated Average Number of People	Estimated Water Use (AF)
September	2017	124	0	21	145	0.7
October	2017	175	0	21	196	1.0
November	2017	69	0	21	90	0.5
December	2017	50	0	21	71	0.4
January	2018	194	0	21	215	1.1
February	2018	238	0	21	259	1.2
March	2018	209	0	21	230	1.2
April	2018	116	0	21	137	0.7
May	2018	363	0	21	384	2.0
June	2018	923	158	21	1,101	5.6
July	2018	470	315	21	806	4.2
August	2018	258	158	21	436	2.3
<b>Annual Total</b>						<b>21</b>

### 2.2.2 Swimming Pool Evaporation

Camp Ramah has two (2) swimming pools that are filled all year round. The total surface area of the two (2) swimming pools is 0.13 acres.

Pan evaporation data from the Western Regional Climate Center's (WRCC) Southwest Climate and Environmental Information Collaborative (SCENIC) closest station to Camp Ramah, Cachuma Lake station, was found from September 2017 to August 2018 (**Table 3**). The yearly total pan evaporation was 81 inches. Assuming that the swimming pools also lost 81 inches (i.e. 6.75 feet) of water per year to evaporation, the swimming pools would lose approximately 1 AFY to evaporation, which would need to be replenished by District water.

**Table 3: WRCC SCENIC Cachuma Lake Station Pan Evaporation**

Month	Year	Monthly Pan Evaporation (inch)
September	2017	11.6
October	2017	7.6
November	2017	4.0
December	2017	3.7
January	2018	3.5
February	2018	3.9
March	2018	5.4
April	2018	5.5
May	2018	7.7
June	2018	8.8
July	2018	10.1
August	2018	9.1
<b>Annual Total</b>		<b>81</b>

### 2.2.3 Estimated Reservoir Evaporation

Camp Ramah has a 3 million gallon reservoir that is used to supply water to all fire hydrants at the Camp as well as supply the irrigation system. The reservoir is uncovered and has a surface area of 0.68 acres.

Assuming that the reservoir lost 81 inches (i.e. 6.75 feet) of water per year to evaporation (like the Cachuma Lake WRCC SCENIC Station), the reservoir would lose approximately 4.6 AFY to evaporation, which would need to be replenished by District water.

### 2.2.4 Estimated Irrigation Demand

Camp Ramah has five (5) irrigated landscape areas that total 6.5 acres of irrigated land, as presented in **Table 4**. According to Camp records, all 6.5 acres are Bermuda grass.

**Table 4: Camp Ramah's Irrigated Land**

Description	Area (acres)
Baseball field	3.00
Dining hall lawn	2.75
Adult housing/library	0.18
Climbing frame lawn	0.30
Bunks	0.27
<b>Total</b>	<b>6.50</b>

Camp Ramah is located in the North Central Plateau & Central Coast Range (Zone 10) Reference Evapotranspiration (ET<sub>o</sub>) Zone as defined by the California Irrigation Management Information System (CIMIS). Zone 10 has an annual reference evapotranspiration of 49.1 inches. Bermuda grass has an annual average crop coefficient (K<sub>c</sub>) of 0.6<sup>1</sup>.

Therefore, Camp Ramah's total irrigated land is projected to require 16 AFY<sup>2</sup>.

<sup>1</sup> Meyer et al. 1985. Irrigation of turfgrass below replacement of evapotranspiration as a means of water conservation: determining crop coefficient of turfgrasses, pp. 357-364 in: F. Lemaire (ed.) Proc. 5th Intl. Turfgrass Research Conf., Avignon, France, July 1985. INRA Publications, Versailles, France.

<sup>2</sup> ET<sub>o</sub>\*K<sub>c</sub>\*Area = (49.1 inch/year)\*(1 foot / 12 inch)\*(0.6)\*(6.5 acre) = 16 AFY

## 2.2.5 Total Projected Water Demand

Total projected water demand for the Camp is the sum of the estimated water use by camp guests and staff, swimming pool evaporation, reservoir evaporation and landscape irrigation. As shown in **Table 5**, the Camp's projected annual demand is estimated at 42.6 AFY.

**Table 5: Camp Ramah's Projected Water Demand**

Type of Use	Projected Water Demand (AFY)
Indoor water use of people	21
Swimming pool evaporation	1
Reservoir evaporation	4.6
Irrigation demand	16
<b>Annual Total</b>	<b>42.6</b>

## 2.3 Total Water Use from Representative Base Period

The District was asked to provide Camp Ramah's monthly meter data from 2008 to 2018. Meter data associated with account 41-25674-00 was obtained from the District (**Attachment C**). The monthly meter data was from August 2008 to July 2018 (missing the months of December 2009 and April 2014). The District began meter data reports for Camp Ramah in August 2008; therefore, there are no meter data for January 2008 through July 2008. The annual water use summary of this meter data is listed in **Table 6**. The average monthly water use from 2008 to 2018 was 3.6 AFY. Therefore, the annual average water use was approximately 43 AFY.

**Table 6: Camp Ramah's Water Use from District Meter Data**

Year	Metered Water Use (AFY)	Average Monthly Water Use (AFY)
2008	21**	4.2
2009	49*	4.5
2010	40	3.3
2011	40	3.3
2012	47	3.9
2013	55	4.6
2014	45*	4.1
2015	31	2.6
2016	29	2.4
2017	39	3.2
2018	21**	3.0

\* Missing one month of water use from annual total water use

\*\* Missing more than one month of water use from annual total water use

## 2.4 Metered Groundwater Data

Camp Ramah's well (SWN 04N23W02D01) did not produce any water since it was installed on March 31, 2016. The well is not anticipated to produce water in the near future; therefore, well information was not included in this memorandum.

## 3 Conclusions

Based on the information provided herein, it is concluded:

1. The District allocation for the main camp account (District Account 41-25674-00) is 37.05 AFY.
2. The Projected Water Demand for all the current uses of Camp Ramah is estimated at 42.6 AFY.
3. As presented in **Table 6**, the Camp's historical water use averages to 43 AFY.
4. Camp Ramah's groundwater well is not producing water.

In conclusion, **Table 6** shows that while there are at most eight (8) of the last ten (10) years where Camp Ramah's water use was above the main camp of Camp Ramah's allocation of 37.05 AFY (assuming 2018 has an annual total greater than 37 AFY), Camp Ramah has used less than its 37.05 AFY allocation in the two (2) of the three (3) most recent years (2015 & 2016). Since the Major Modification will not increase the number of campers or land irrigated, Camp Ramah is expected to follow this recent trend and maintain water use under 37.05 AFY for 2018 and beyond.





# Attachment A

---

Camp Ramah Existing Accounts with  
Casitas Municipal Water District



## Allocation Information Summary

File Edit Options Help

Account Number

41-25674-00

CAMP RAMAH IN CALIFORNIA

Allocation Info

385

FAIRVIEW RD

Allocation Method

Annual

Total Annual Allocation

37.05

acre-feet

x 435.6 =

16139

units

Current Stage

0.90

Dwellings on Property

1.00

Annual Essential Usage

0

Annual NonEssential Usage

16139

x Current Stage Reduction

0.90

= Current Annual Non-Essential

14525

Penalty Per Unit Over Allocation

5.00

## Monthly Non-Essential Annual Allocation Percentages

Jul	Aug	Sep	Oct	Nov	Dec	Jan	Feb	Mar	Apr	May	Jun
0.00	0.00	0.00	0.00	0.00	0.00	0.00	0.00	0.00	0.00	0.00	1.00

## Monthly Allocation Calculation at Current Rates

	Jul	Aug	Sep	Oct	Nov	Dec	Jan	Feb	Mar	Apr	May	Jun
Essential	0	0	0	0	0	0	0	0	0	0	0	0
Non-Essential	0	0	0	0	0	0	0	0	0	0	0	14525
Total	0	0	0	0	0	0	0	0	0	0	0	14525

Utility Account

Calculation Detail

 Clear

View

ckelley

File Edit Options Help



Account Number 40-25682-01

CAMP RAMAH IN CALIFORNIA

Allocation Info

455 FAIRVIEW RD

Allocation Method Annual

Total Annual Allocation 9.04 acre-feet x 435.6 = 3938 units

Current Stage 0.90

Dwellings on Property 1.00

Annual Essential Usage 0

Annual NonEssential Usage 3938 x Current Stage Reduction 0.90 = Current Annual Non-Essential 3544

Penalty Per Unit Over Allocation 5.00

Monthly Non-Essential Annual Allocation Percentages

Jul	Aug	Sep	Oct	Nov	Dec	Jan	Feb	Mar	Apr	May	Jun
0.00	0.00	0.00	0.00	0.00	0.00	0.00	0.00	0.00	0.00	0.00	1.00

Monthly Allocation Calculation at Current Rates

	Jul	Aug	Sep	Oct	Nov	Dec	Jan	Feb	Mar	Apr	May	Jun
Essential	0	0	0	0	0	0	0	0	0	0	0	0
Non-Essential	0	0	0	0	0	0	0	0	0	0	0	3544
Total	0	0	0	0	0	0	0	0	0	0	0	3544

Utility Account

Calculation Detail

Clear

View

ckelley



# Attachment B

---

Camp Ramah Estimated Attendance Record 9/2017 – 8/2018



DATE	GROUP	Estimated Number of Guests	Type of Rental
September 15 - 17, 2017	Mizel/Goldin Bat Mitzvah	350	Jewish Community
September 22 -24, 2017	Ventura College Stdnt Govt Retreat	25	Local Community
September 20 -24, 2017	Tune Up Fitness	120	Rental
October 13 - 15, 2017	Chinese Evangelical	75	Local Community
October 20 - 22, 2017	Sinai Temple Teen Center	75	Jewish Community
October 27 - 29, 2017	Camp Yoga	150	Rental
October 17 - 19, 2017	Molly Menashe Bat Mitzvah	400	Jewish Community
November 10 - 12, 2017	USY LTE	150	Jewish Community
November 10 - 12, 2017	Congregation B'nai B'rith of SB	125	Local Community
December 1-3, 2017	Adat Ari El JLC	75	Jewish Community
December 1-3, 2017	Shomrei Torah Shabbaton (Joint with TA)	75	Jewish Community
December 1-3, 2017	Temple Aliyah Shabbaton (Joint with ST)	50	Jewish Community
January 4-7, 2018	Weinstein Institute/Lay Leaders Shabbaton	115	Jewish Community
January 12-14, 2018	Adat Ari El Family Camp	175	Jewish Community
January 19-20,2018	Congregation B'nai B'rith of Santa Barbara	50	Local Community
January 19-20,2018	USY/Kadima Kinnus Shabbaton	235	Jewish Community
<b>January 19-20,2018</b>	<b>Ramah Children</b>	70	<b>Internal</b>
January 26-28,2018	The Roxanne Retreat	30	Rental
January 26-28,2018	Stephen S. Wise Shabbaton	100	Jewish Community
February 2-4, 2018	Congregation Ner Tamid	75	Jewish Community
February 2-4, 2018	Sinai Religious School Shabbaton	125	Jewish Community
February 14-19, 2018	Israeli Scouts	750	Jewish Community
March 2-4, 2018	Adat Ari El Day School	200	Jewish Community
<b>March 2-4, 2018</b>	<b>Ezra Weekend</b>	20	<b>Internal</b>
<b>March 9-11, 2018</b>	<b>ECFC</b>	75	<b>Internal</b>
March 9-11, 2018	Temple Israel Women's Retreat	40	Jewish Community
March 16-18, 2018	Sinai Temple Family Retreat	200	Jewish Community
March 23-25, 2018	Light/Levine Wedding	300	Jewish Community
April 13-15, 2018	California School Educators Association	100	Local Community
<b>April 13-15, 2018</b>	<b>ECFC</b>	75	<b>Internal</b>
April 19-22, 2018	Rotary Youth Leadership Awards	240	Local Community
<b>April 27-29, 2018</b>	<b>Ruach Nashim</b>	50	<b>Internal</b>
May 4-6, 2018	IKAR	250	Jewish Community
May 11-13, 2018	Temple Beth Am LA	200	Jewish Community
May 14-22, 2018	A-Camp	300	Rental
May 24-28, 2018	Israeli Scouts	700	Jewish Community
June 1-3, 2018	Reynolds Wedding	300	Jewish Community
June 8-10, 2018	Spitzer Wedding	300	Jewish Community
June 6, 2018	Mattes Bar Mitzvah	50	Jewish Community
<b>June 12-August 17, 2018</b>	<b>Summer</b>	1000	<b>Internal</b>
<b>TOTAL</b>		<b>7800</b>	







# Attachment C

---

Casitas Municipal Water District Meter Data  
for Camp Ramah



Account Number - 41-25674-00 CAMP RAMAH IN CALIFORNIA Service Address: 385 FAIRVIEW RD

Service: 100 20 P-M-OTHER METERS Meter: 2792589

		Read		Total	Demand		Reading		
Month	Date	Previous	Current	Consumption	Read	Consumption	Flag	Source	Occupant
Year : 2018 Total 7									
Jul	08/01/2018	404815	407585	2770	37.0500	37.0500	Regular	Hand Held	00
Jun	07/02/2018	402640	404815	2175	37.0500	37.0500	Regular	Hand Held	00
May	06/01/2018	401310	402640	1330	37.0500	37.0500	Regular	Hand Held	00
Apr	05/01/2018	400790	401310	520	37.0500	37.0500	Regular	Hand Held	00
Mar	04/02/2018	399935	400790	855	37.0500	37.0500	Regular	Hand Held	00
Feb	03/01/2018	399485	399935	450	37.0500	37.0500	Regular	Hand Held	00
Jan	02/01/2018	398335	399485	1150	37.0500	37.0500	Regular	Hand Held	00
Year : 2017 Total 12									
Dec	01/02/2018	397385	398335	950	37.0500	37.0500	Regular	Hand Held	00
Nov	12/01/2017	396400	397385	985	37.0500	37.0500	Regular	Hand Held	00
Oct	11/02/2017	395075	396400	1325	37.0500	37.0500	Regular	Hand Held	00
Sep	10/09/2017	393306	395075	1769	37.0500	37.0500	Regular	Manual Read	00
Aug	09/06/2017	390785	393306	2521	29.0200	29.0200	Regular	Manual Read	00
Jul	08/02/2017	388120	390785	2665	29.0200	29.0200	Regular	Hand Held	00
Jun	07/03/2017	385400	388120	2720	29.0200	29.0200	Regular	Hand Held	00
May	06/01/2017	383890	385400	1510	29.0200	29.0200	Regular	Hand Held	00
Apr	05/02/2017	382750	383890	1140	29.0200	29.0200	Regular	Hand Held	00
Mar	04/03/2017	381985	382750	765	29.0200	29.0200	Regular	Hand Held	00
Feb	03/01/2017	381605	381985	380	29.0200	29.0200	Regular	Hand Held	00
Jan	02/01/2017	381405	381605	200	29.0200	29.0200	Regular	Hand Held	00
Year : 2016 Total 12									
Dec	01/03/2017	380385	381405	1020	29.0200	29.0200	Regular	Hand Held	00
Nov	12/02/2016	380210	380385	175	29.0200	29.0200	Regular	Hand Held	00
Oct	11/02/2016	378775	380210	1435	29.0200	29.0200	Regular	Hand Held	00
Sep	10/03/2016	378370	378775	405	29.0200	29.0200	Regular	Hand Held	00
Aug	09/02/2016	376435	378370	1935	29.0200	29.0200	Regular	Hand Held	00
Jul	08/05/2016	373600	376435	2835	29.0200	29.0200	Regular	Hand Held	00
Jun	07/03/2016	372030	373600	1570	29.0200	29.0200	Regular	Hand Held	00
May	06/03/2016	370525	372030	1505	29.0200	29.0200	Regular	Hand Held	00
Apr	05/04/2016	370135	370525	390	29.0200	29.0200	Regular	Hand Held	00
Mar	04/05/2016	369970	370135	165	29.0200	29.0200	Regular	Hand Held	00
Feb	03/02/2016	369625	369970	345	29.0200	29.0200	Regular	Hand Held	00
Jan	02/02/2016	368825	369625	800	29.0200	29.0200	Regular	Hand Held	00
Year : 2015 Total 12									
Dec	01/04/2016	368500	368825	325	29.0200	29.0200	Regular	Hand Held	00
Nov	12/02/2015	367810	368500	690	29.0200	29.0200	Regular	Hand Held	00
Oct	11/02/2015	366550	367810	1260	29.0200	29.0200	Regular	Hand Held	00
Sep	10/02/2015	365870	366550	680	29.0200	29.0200	Regular	Hand Held	00
Aug	09/02/2015	364450	365870	1420	29.0200	29.0200	Regular	Hand Held	00
Jul	08/04/2015	362275	364450	2175	29.0200	29.0200	Regular	Hand Held	00
Jun	07/06/2015	359770	362275	2505	34.8200	34.8200	Regular	Hand Held	00
May	06/01/2015	357660	359770	2110			Regular	Hand Held	00
Apr	05/04/2015	357015	357660	645			Regular	Hand Held	00
Mar	04/02/2015	356725	357015	290			Regular	Hand Held	00
Feb	03/02/2015	356460	356725	265			Regular	Hand Held	00
Jan	02/02/2015	355435	356460	1025			Regular	Hand Held	00
Year : 2014 Total 12									
Dec	01/06/2015	355380	355435	55			Regular	Hand Held	00
Nov	12/04/2014	354545	355380	835			Regular	Hand Held	00
Oct	11/03/2014	353660	354545	885			Regular	Hand Held	00
Sep	10/06/2014	352175	353660	1485			Regular	Hand Held	00
Aug	09/03/2014	350010	352175	2165			Regular	Hand Held	00
Jul	08/04/2014	346230	350010	3780			Regular	Hand Held	00
Jun	07/02/2014	341890	346230	4340			Regular	Hand Held	00
May	06/03/2014	340080	341890	1810			Regular	Hand Held	00

Account Number - 41-25674-00 CAMP RAMAH IN CALIFORNIA Service Address: 385 FAIRVIEW RD

Service: 100 20 P-M-OTHER METERS Meter: 2792589

		Read		Total	Demand		Reading		
Month	Date	Previous	Current	Consumption	Read	Consumption	Flag	Source	Occupant
Mar	04/03/2014	338550	339160	610			Regular	Hand Held	00
Feb	03/05/2014	337975	338550	575			Regular	Hand Held	00
Jan	02/04/2014	335005	337975	2970			Regular	Hand Held	00

Year : 2013 Total 12

Dec	01/02/2014	333670	335005	1335			Regular	Hand Held	00
Nov	12/03/2013	332960	333670	710			Regular	Hand Held	00
Oct	11/04/2013	328860	332960	4100			Regular	Hand Held	00
Sep	10/01/2013	326955	328860	1905			Regular	Hand Held	00
Aug	09/04/2013	325195	326955	1760			Regular	Hand Held	00
Jul	08/02/2013	320310	325195	4885			Regular	Hand Held	00
Jun	07/02/2013	316170	320310	4140			Regular	Hand Held	00
May	06/04/2013	315140	316170	1030			Regular	Hand Held	00
Apr	05/02/2013	311940	315140	3200			Regular	Hand Held	00
Mar	04/04/2013	311270	311940	670			Regular	Hand Held	00
Feb	03/06/2013	310860	311270	410			Regular	Hand Held	00
Jan	02/06/2013	309270	310860	1590			Regular	Hand Held	00

Year : 2012 Total 12

Dec	01/09/2013	308840	309270	430			Regular	Hand Held	00
Nov	12/03/2012	308525	308840	315			Regular	Hand Held	00
Oct	11/08/2012	304615	308525	3910			Regular	Hand Held	00
Sep	10/02/2012	302630	304615	1985			Regular	Hand Held	00
Aug	09/06/2012	299700	302630	2930			Regular	Hand Held	00
Jul	08/01/2012	297170	299700	2530			Regular	Hand Held	00
Jun	07/05/2012	293630	297170	3540			Regular	Hand Held	00
May	06/01/2012	293015	293630	615			Regular	Hand Held	00
Apr	05/01/2012	292435	293015	580			Regular	Hand Held	00
Mar	04/02/2012	289575	292435	2860			Regular	Hand Held	00
Feb	03/02/2012	289075	289575	500			Regular	Hand Held	00
Jan	02/07/2012	288725	289075	350			Regular	Hand Held	00

Year : 2011 Total 12

Dec	01/05/2012	288155	288725	570			Regular	Hand Held	00
Nov	12/08/2011	286920	288155	1235			Regular	Hand Held	00
Oct	11/09/2011	283500	286920	3420			Regular	Hand Held	00
Sep	10/07/2011	282695	283500	805			Regular	Hand Held	00
Aug	09/06/2011	281360	282695	1335			Regular	Hand Held	00
Jul	08/09/2011	276620	281360	4740			Regular	Hand Held	00
Jun	07/01/2011	275040	276620	1580			Regular	Hand Held	00
May	06/06/2011	273480	275040	1560			Regular	Hand Held	00
Apr	05/03/2011	272035	273480	1445			Regular	Hand Held	00
Mar	04/07/2011	271790	272035	245			Regular	Hand Held	00
Feb	03/08/2011	271545	271790	245			Regular	Hand Held	00
Jan	02/07/2011	271305	271545	240			Regular	Hand Held	00

Year : 2010 Total 12

Dec	01/04/2011	270950	271305	355			Regular	Hand Held	00
Nov	12/03/2010	269695	270950	1255			Regular	Hand Held	00
Oct	11/07/2010	267550	269695	2145			Regular	Hand Held	00
Sep	10/02/2010	265530	267550	2020			Regular	Hand Held	00
Aug	08/30/2010	262240	265530	3290			Regular	Hand Held	00
Jul	07/31/2010	258910	262240	3330			Regular	Hand Held	00
Jun	06/30/2010	256535	258910	2375			Regular	Hand Held	00
May	06/08/2010	256030	256535	505			Regular	Hand Held	00
Apr	05/11/2010	254670	256030	1360			Regular	Hand Held	00
Mar	04/06/2010	254310	254670	360			Regular	Hand Held	00
Feb	03/04/2010	254100	254310	210			Regular	Hand Held	00
Jan	02/03/2010	254000	254100	100			Regular	Hand Held	00

Year : 2009 Total 12

Dec	01/03/2009	253745	254000	255			Regular	Hand Held	00
-----	------------	--------	--------	-----	--	--	---------	-----------	----

Account Number - 41-25674-00 CAMP RAMAH IN CALIFORNIA Service Address: 385 FAIRVIEW RD  
Service: 100 20 P-M-OTHER METERS Meter: 2792589

		Read		Total	Demand		Reading		
Month	Date	Previous	Current	Consumption	Read	Consumption	Flag	Source	Occupant
Nov	12/09/2009	252800	253745	945			Regular	Hand Held	00
Oct	11/13/2009	251390	252800	1410			Regular	Hand Held	00
Sep	10/13/2009	250055	251390	1335			Regular	Hand Held	00
Aug	09/15/2009	246440	250055	3615			Regular	Hand Held	00
Jul	08/11/2009	241445	246440	4995			Regular	Hand Held	00
Jun	07/07/2009	238095	241445	3350			Regular	Hand Held	00
May	06/08/2009	235855	238095	2240			Regular	Hand Held	00
Apr	05/07/2009	235140	235855	715			Regular	Hand Held	00
Mar	04/10/2009	233145	235140	1995			Regular	Hand Held	00
Feb	03/04/2009	232960	233145	185			Regular	Hand Held	00
Jan	02/09/2009	232385	232960	575			Regular	Hand Held	00
Year : 2008 Total 5									
Dec	01/09/2009	232195	232385	190			Regular	Hand Held	00
Nov	12/08/2008	230650	232195	1545			Regular	Hand Held	00
Oct	11/04/2008	228550	230650	2100			Regular	Hand Held	00
Sep	10/09/2008	225835	228550	2715			Regular	Hand Held	00
Aug	09/07/2008	223210	225835	2625			Regular	Hand Held	00
				Avg 1536			Avg 10		